

THIS DRAWING IS UNPUBLISHED. RELEASED FOR PUBLICATION
 © COPYRIGHT - By - ALL RIGHTS RESERVED.

| LOC | DIST | REVISIONS | | | | | |
|-----|------|-----------|-----|------------------|---------------|-----------|-------|
| J | - | P | LTR | DESCRIPTION | DATE | DWN | APVD |
| | | | D2 | REDRAWN W/CHANGE | ECR-12-021403 | 13DEC2012 | TS KB |

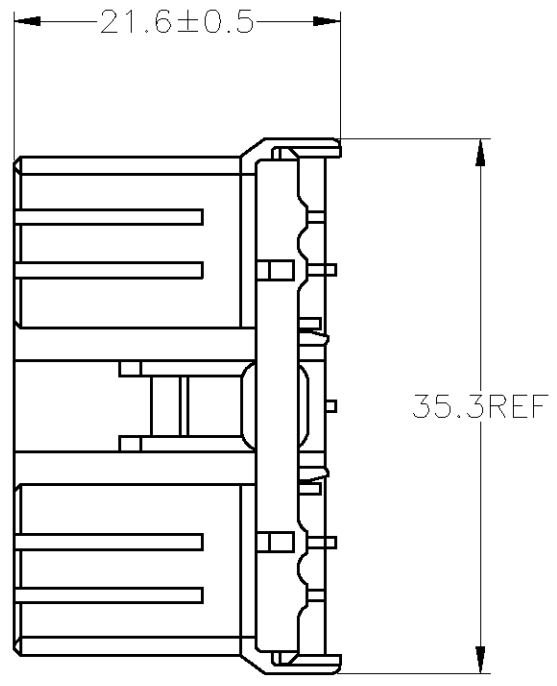
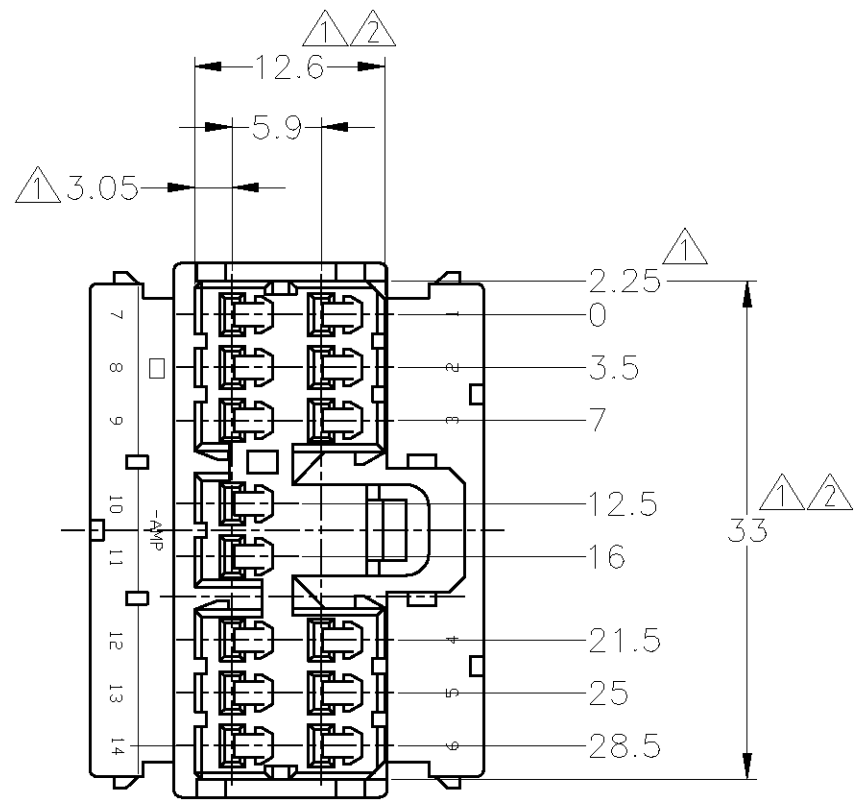

△ MUST BE KEPT BETWEEN [-A-] AND 2
 △ TO BE MATED WITH THE CAP HOUSING SMOOTHLY
 3. APPLIED RECEPTACLE CONTACT PART NUMBER; 173630 AND 173631

△ [-A-] 面より2mmの範囲で測定
 △ 相手ハウジングと所定の機能を満足して嵌合できること
 3. 内装するリセプタクルコンタクト型番173630 及び 173631

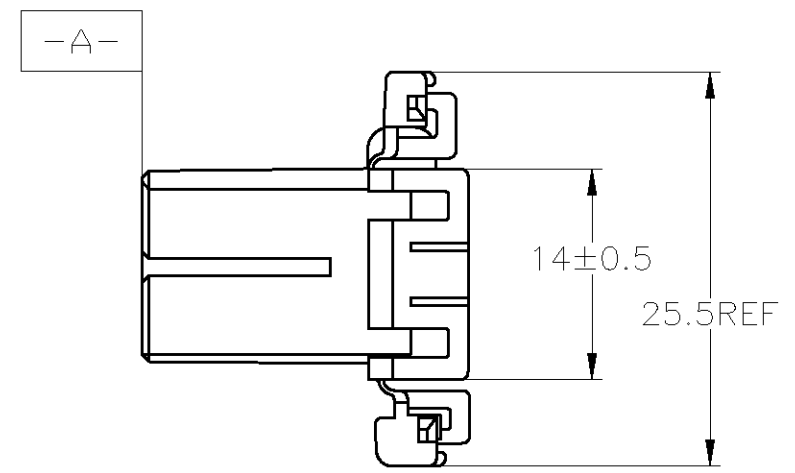

| | | | |
|---------------------------------------|-----|---------------|------------------|
| OBSOLETE | V-2 | 自然色 (NATURAL) | 1-173852-1 |
| | HB | 黄 (YELLOW) | 173852-7 |
| | | 灰 (GRAY) | 173852-6 |
| | | 青 (BLUE) | 173852-5 |
| | | 緑 (GREEN) | 173852-4 |
| | | 黒 (BLACK) | 173852-2 |
| | | 自然色 (NATURAL) | 173852-1 |
| 使用材料難燃グレード (FLAMMABILITY OF MATERIAL) | | 色 (COLOR) | 型番 (PART NUMBER) |

THIS DRAWING IS A CONTROLLED DOCUMENT.

| | | | | | |
|---------------------------|----------|---|-----------------|----------------------|---------------|
| DWN T.SHINOHARA 13DEC2012 | | 070 SERIES MULTI-LOCK CONNECTOR 14POSITION PLUG HOUSING | | | |
| CHK K.BETSUI 13DEC2012 | | NAME 名称 | | | |
| APVD K.BUTSUI 13DEC2012 | | PRODUCT SPEC 製品規格 | 108-5216,5264 | | |
| | | APPLICATION SPEC 取付適用規格 | | | |
| | WEIGHT - | SIZE A3 | CAGE CODE 00779 | DRAWING NO. C-173852 | RESTRICTED TO |
| CUSTOMER DRAWING | | SCALE 尺度 2:1 | SHEET 1 OF 1 | REV D2 | |

TOLERANCES UNLESS OTHERWISE SPECIFIED: 一般公差

| | |
|-----------|-------|
| 10± | ±0.2 |
| 30± > 10 | ±0.25 |
| 100± > 30 | ±0.3 |
| ANGLE | ±3° |

DIMENSIONS: 単位: 耗 mm

| | |
|---|-----|
| TOLERANCES UNLESS OTHERWISE SPECIFIED: 一般公差 | |
| 0 PLC | ±- |
| 1 PLC | ±- |
| 2 PLC | ±- |
| 3 PLC | ±- |
| 4 PLC | ±- |
| ANGLES | ±- |
| MATERIAL 材料 | PBT |
| FINISH 仕上 | - |